

PROPERTY DISCLOSURE 2024 ADDENDUM (Flood Hazard)

For Property Located At: 865 Aroostook Scenic Highway, Moro Plt, ME 04780

For the purposes of this section, Maine law defines "flood" as follows:

- (1) A general and temporary condition of partial or complete inundation of normally dry areas from: (a) The overflow of inland or tidal waters; or (b) The unusual and rapid accumulation or runoff of surface waters from any source; or
- (2) The collapse or subsidence of land along the shore of a lake or other body of water as a result of erosion or undermining caused by waves or currents of water exceeding anticipated cyclical levels or suddenly caused by an unusually high water level in a natural body of water, accompanied by a severe storm or by an unanticipated force of nature, such as a flash flood or an abnormal tidal surge, or by some similarly unusual and unforeseeable event that results in flooding as described in subparagraph (1), division (a).

For purposes of this section, Maine law defines "area of special flood hazard" as land in a floodplain having 1% or greater chance of flooding in any given year, as identified in the effective federal flood insurance study and corresponding flood insurance rate maps.

During the time the seller has owned the property:

Have any flood events affected the property? ☐ Yes ☒ No ☐ Unknown

~~If Yes, explain: _____~~

Have any flood events affected a structure on the property? ☐ Yes ☒ No ☐ Unknown

~~If Yes, explain: _____~~

Has any flood-related damage to a structure occurred on the property? ... ☐ Yes ☒ No ☐ Unknown

~~If Yes, explain: _____~~

Has there been any flood insurance claims filed for a structure on the property? ☐ Yes ☒ No ☐ Unknown

~~If Yes, indicate the dates of each claim. _____~~

Has there been any past disaster-related aid provided related to the property or a structure on the property from federal, state or local sources for purposes of flood recovery? ☐ Yes ☒ No ☐ Unknown

~~If Yes, indicate the date of each payment. _____~~

Buyer Initials _____

Page 1 of 2

Seller Initials

Initial
PJP

Initial
JP

For Property Located At: 865 Aroostook Scenic Highway, Moro Plt, ME 04780

Is the property currently located wholly or partially within an area of special flood hazard mapped on the effective flood insurance rate map issued by the Federal Emergency Management Agency on or after March 4, 2002?

☐ Yes ☐ No ☒ Unknown

If yes, what is the federally designated flood zone for the property indicated on that flood insurance rate map?

Relevant Panel Number: _____ Year: _____ (Attach a copy)

Comments: No map was located, attached a LUPC map. Home location elevation is not at risk for wetlands area

Source of information: LUPC Map, Home Location

Signed by: _____
Peter J. Pauly 8/9/2024
Seller 76499D0D46A... Date
Peter J. Pauly

Signed by: _____
Tanja Pauly 8/9/2024
Seller 1AE3A4A01479... Date
Tanja Pauly

Seller _____ Date _____

Seller _____ Date _____

The undersigned hereby acknowledge receipt of this Property Disclosure Addendum.

Buyer _____ Date _____

Buyer _____ Date _____

Buyer _____ Date _____

Buyer _____ Date _____

Page 2 of 2



Maine Association of REALTORS®/Copyright © 2024.
All Rights Reserved. Published July 2024.



LUPC Zoning and Parcel Viewer

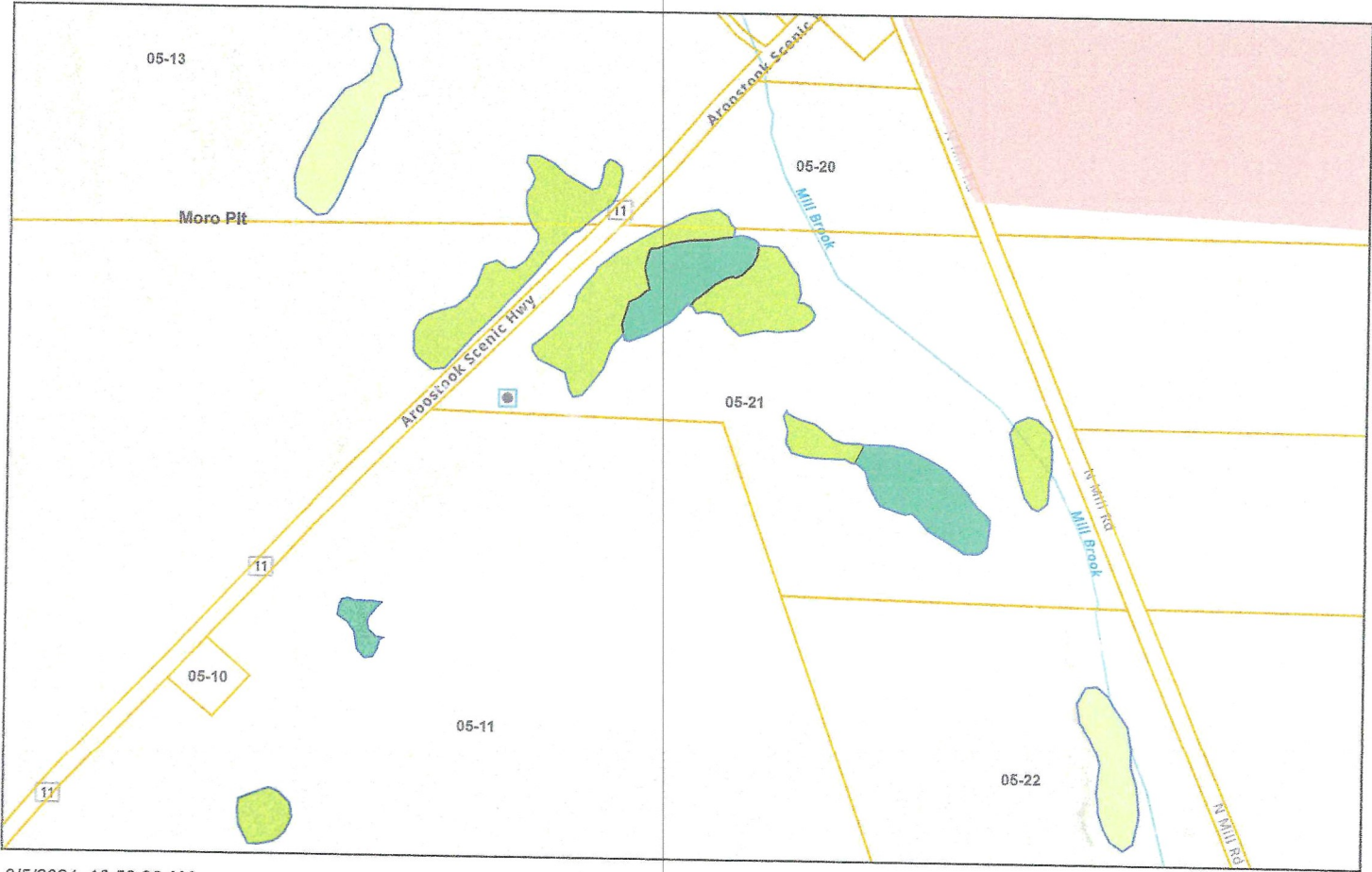

8/5/2024, 10:58:36 AM

- Towns
- LUPC Zones Layer
- M-GN: General Management
 - P-SL2: Shoreland - 75' Protection
 - P-WL1: Wetlands of Special Significance Protection
 - P-WL2: Scrub-shrub Wetlands Protection
 - P-WL3: Forested Wetlands Protection
 - Unorganized Territory Parcels
 - D-RS: Residential Development

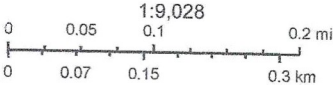

Esri, NASA, NGA, USGS, Esri Community Maps Contributors, Province of New Brunswick, © OpenStreetMap, Microsoft, Esri Canada, Esri, TomTom, Maine Land Use Planning Commission 2018