

Stonefort 50
TBD Fritts Road
Stonefort, IL 62987

\$300,000
50± Acres
Saline County



Stonefort 50
Stonefort, IL / Saline County

SUMMARY

Address

TBD Fritts Road

City, State Zip

Stonefort, IL 62987

County

Saline County

Type

Lakefront, Lot, Recreational Land

Latitude / Longitude

37.6712 / -88.6834

Taxes (Annually)

300

Acreage

50

Price

\$300,000

Property Website

<https://livingthedreamland.com/property/stonefort-50-saline-illinois/64728/>

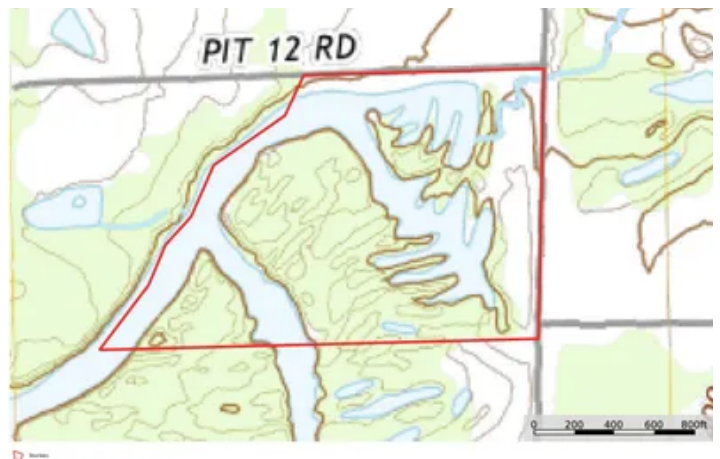

MORE INFO ONLINE:

<https://livingthedreamland.com/>



Stonefort 50
Stonefort, IL / Saline County

PROPERTY DESCRIPTION

Explore your outdoor paradise in Saline County, IL! This beautiful 50-acre property offers a perfect blend of recreation and relaxation, featuring a private boat ramp to a sprawling 36-acre strip lake, ideal for fishing and boating enthusiasts. The land is primarily wooded, providing excellent opportunities for hunting deer, turkey, duck, and small game. There is also a 3-acre hay field along Fritts Road, with water and electric available at the road, adding convenience for future development. The varied terrain is perfect for ATV riding and could be used for horses. The lake is renowned for producing large crappie and bass, making it a fisherman's dream. Situated near the Sahara Woods State Fish and Wildlife Area, with 4,000 acres of outdoor adventures, and close to the Shawnee National Forest with endless trails for hiking, fishing, hunting, horseback riding, and biking, this property is a gateway to nature's best. Experience the best of Southern Illinois living in Saline County—don't miss your chance to own this slice of paradise!



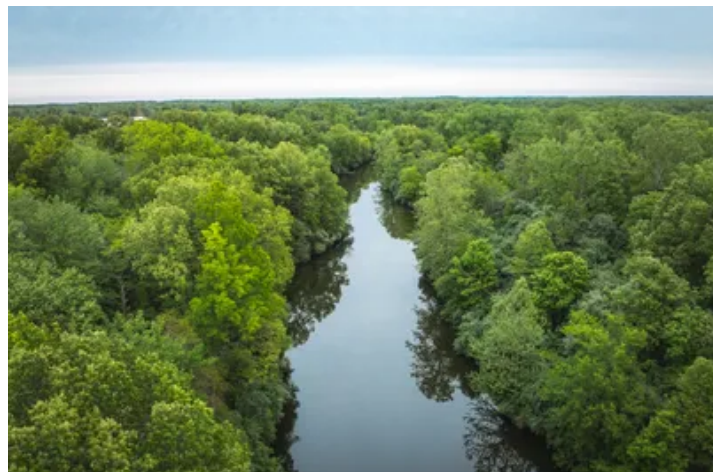

MORE INFO ONLINE:

<https://livingthedreamland.com/>



Locator Map

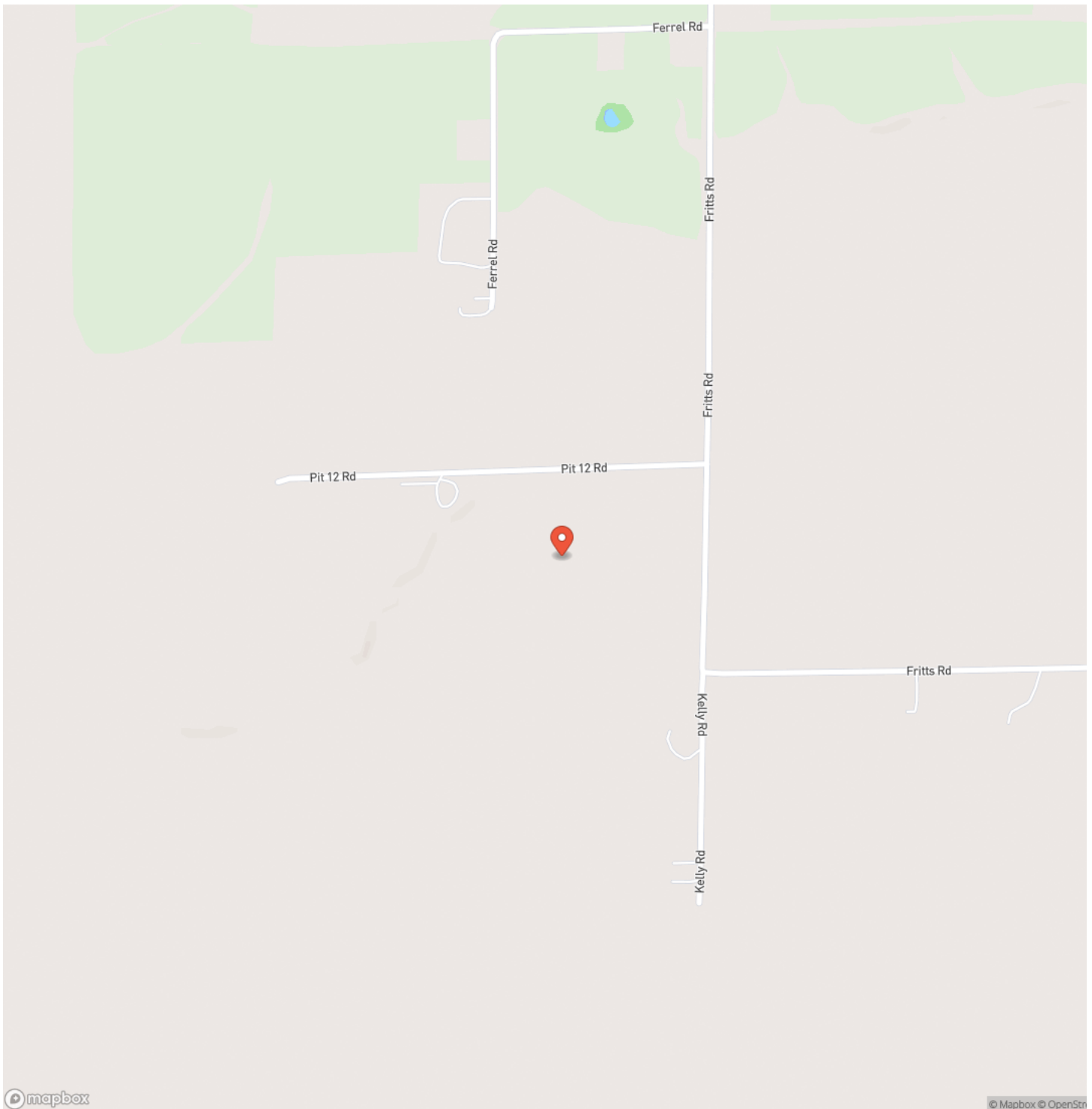

MORE INFO ONLINE:

<https://livingthedreamland.com/>



Locator Map

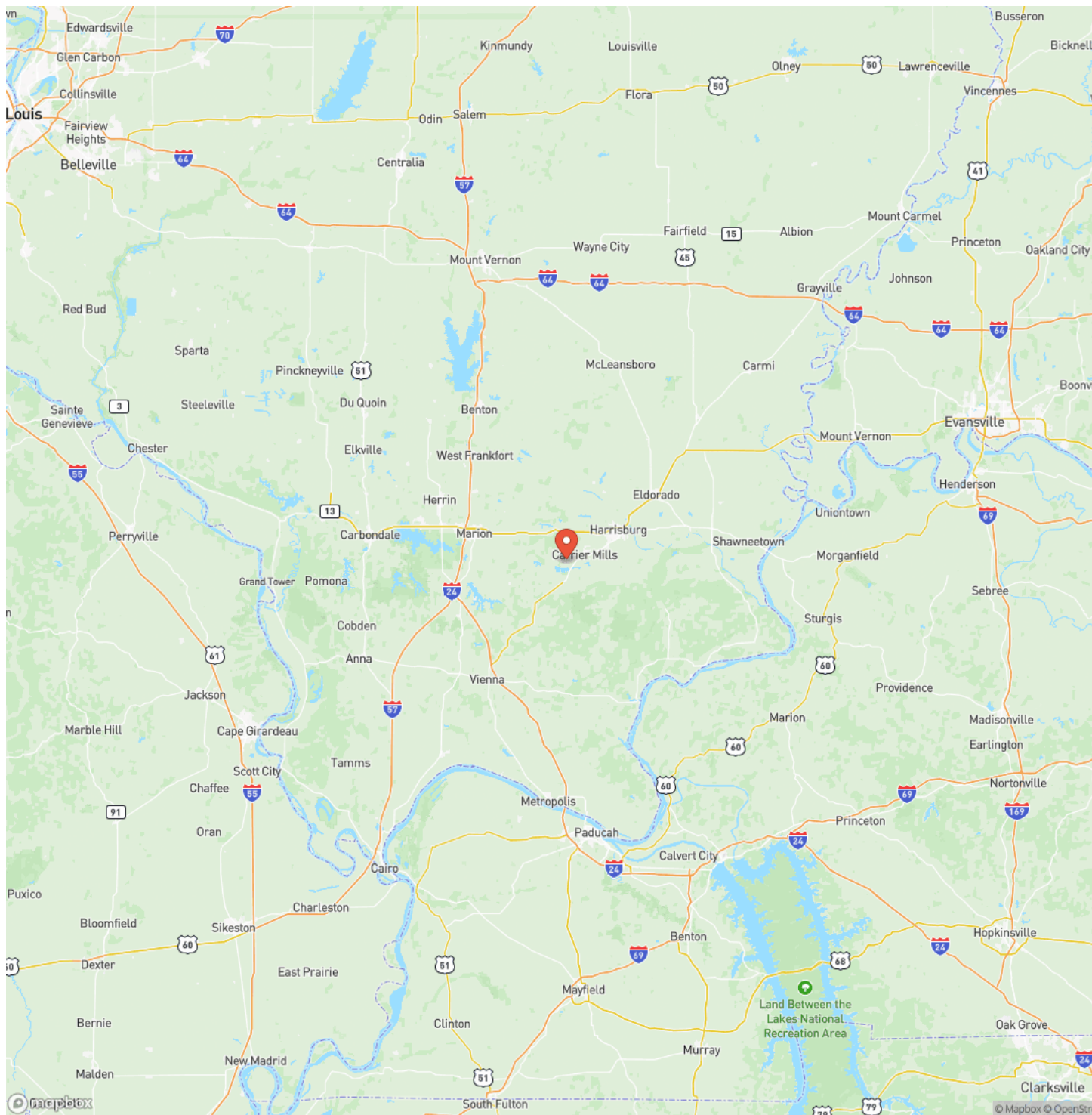

Satellite Map



MORE INFO ONLINE:

<https://livingthedreamland.com/>

Stonefort 50
Stonefort, IL / Saline County

LISTING REPRESENTATIVE

For more information contact:



Representative

Justin Bruehl

Mobile

(618) 410-9496

Email

justinb@livingthedreamland.com

Address

City / State / Zip

Smithton, IL 63005

NOTES

[illegible]

MORE INFO ONLINE:

<https://livingthedreamland.com/>

[illegible]

DISCLAIMERS

Information in this brochure is provided solely for information purposes and does not constitute an offer to sell or advertise real estate outside the states in which broker or agent licensed. The information presented has been obtained from sources deemed to be reliable, but is not guaranteed or warranted by the agent, broker, or the sellers of these properties. This offering is subject to errors, omissions, prior sale, price change, correction or withdrawal from the market without notice. All references to age, square footage, income, expenses, acreage, carrying capacity, and land classification, etc. are approximate. Prospective buyers are chargeable with and expected to conduct their own independent investigation of the information and the property and to rely only on those results. Sellers reserve the right to accept or reject any and all offers without liability to any buyer or cooperating broker.

Maps are provided for illustration purposes only, the accuracy is not warranted. Parcels on interactive maps are not adjusted to match aerial backgrounds. This information is for reference purposes only and is not a legal document. Data maps contain errors. The seller and seller's agent are making known to all potential buyers that there may be variations between the location of the existing fence lines and the legal description of the deeded property. Seller and seller's agent make no warranties with regard to the location of the fence lines in relationship to the deeded property lines, nor does the Seller make any warranties or representations with regard to the specific acreage contained within the fenced property lines. Seller is selling the property in an "as is" condition, which includes the location of the fences as they exist. Boundaries shown on the accompanying maps are approximate, based on county parcel data. The maps are not to scale. The accuracy of the maps is not guaranteed. Prospective buyers are encouraged to verify fence lines, deeded property lines and acreages using a licensed surveyor at their own expense.



Living The Dream Outdoor Properties

6484 North Service Rd.

Leasburg, MO 65535

(855) 289-3478

<https://livingthedreamland.com/>

MORE INFO ONLINE:

<https://livingthedreamland.com/>

