

PROPERTY DISCLOSURE 2024 ADDENDUM (Flood Hazard)

For Property Located At: 589 Lakeville Shores, Lakeville, ME 04487

For the purposes of this section, Maine law defines "flood" as follows:

- (1) A general and temporary condition of partial or complete inundation of normally dry areas from: (a) The overflow of inland or tidal waters; or (b) The unusual and rapid accumulation or runoff of surface waters from any source; or
- (2) The collapse or subsidence of land along the shore of a lake or other body of water as a result of erosion or undermining caused by waves or currents of water exceeding anticipated cyclical levels or suddenly caused by an unusually high water level in a natural body of water, accompanied by a severe storm or by an unanticipated force of nature, such as a flash flood or an abnormal tidal surge, or by some similarly unusual and unforeseeable event that results in flooding as described in subparagraph (1), division (a).

For purposes of this section, Maine law defines "area of special flood hazard" as land in a floodplain having 1% or greater chance of flooding in any given year, as identified in the effective federal flood insurance study and corresponding flood insurance rate maps.

During the time the seller has owned the property:

Have any flood events affected the property? ☐ Yes ☒ No ☐ Unknown

~~If Yes, explain:~~ _____

Have any flood events affected a structure on the property? ☐ Yes ☒ No ☐ Unknown

~~If Yes, explain:~~ _____

Has any flood-related damage to a structure occurred on the property? ... ☐ Yes ☒ No ☐ Unknown

~~If Yes, explain:~~ _____

Has there been any flood insurance claims filed for a structure on the property? ☐ Yes ☒ No ☐ Unknown

~~If Yes, indicate the dates of each claim:~~ _____

Has there been any past disaster-related aid provided related to the property or a structure on the property from federal, state or local sources for purposes of flood recovery? ☐ Yes ☒ No ☐ Unknown

~~If Yes, indicate the date of each payment:~~ _____

Buyer Initials _____

Page 1 of 2

Seller Initials Initial
HMS Initial
HJS _____

For Property Located At: 589 Lakeville Shores, Lakeville, ME 04487

Is the property currently located wholly or partially within an area of special flood hazard mapped on the effective flood insurance rate map issued by the Federal Emergency Management Agency on or after March 4, 2002?

☐ Yes ☐ No ☐ Unknown

If yes, what is the federally designated flood zone for the property indicated on that flood insurance rate map?

No FEMA Map only LUPC Map

Relevant Panel Number: None Year: None (Attach a copy)

Comments: LUPC designation across on extra acreage is Forested Wetlands, on side with home & lake, along shorefront Great Pond Protection

Source of information: Sellers & ~~XXXXXXXXXX~~ Map
LUPC

Signed by: Henrik M. Stavang 8/4/2024
Seller Henrik M. Stavang Date

Signed by: Heather J. Stavang 8/4/2024
Seller Heather J. Stavang Date

Seller _____ Date

Seller _____ Date

The undersigned hereby acknowledge receipt of this Property Disclosure Addendum.

Buyer _____ Date

Buyer _____ Date

Buyer _____ Date

Buyer _____ Date

Page 2 of 2



Maine Association of REALTORS®/Copyright © 2024.
All Rights Reserved. Published July 2024.



LUPC Zoning and Parcel Viewer

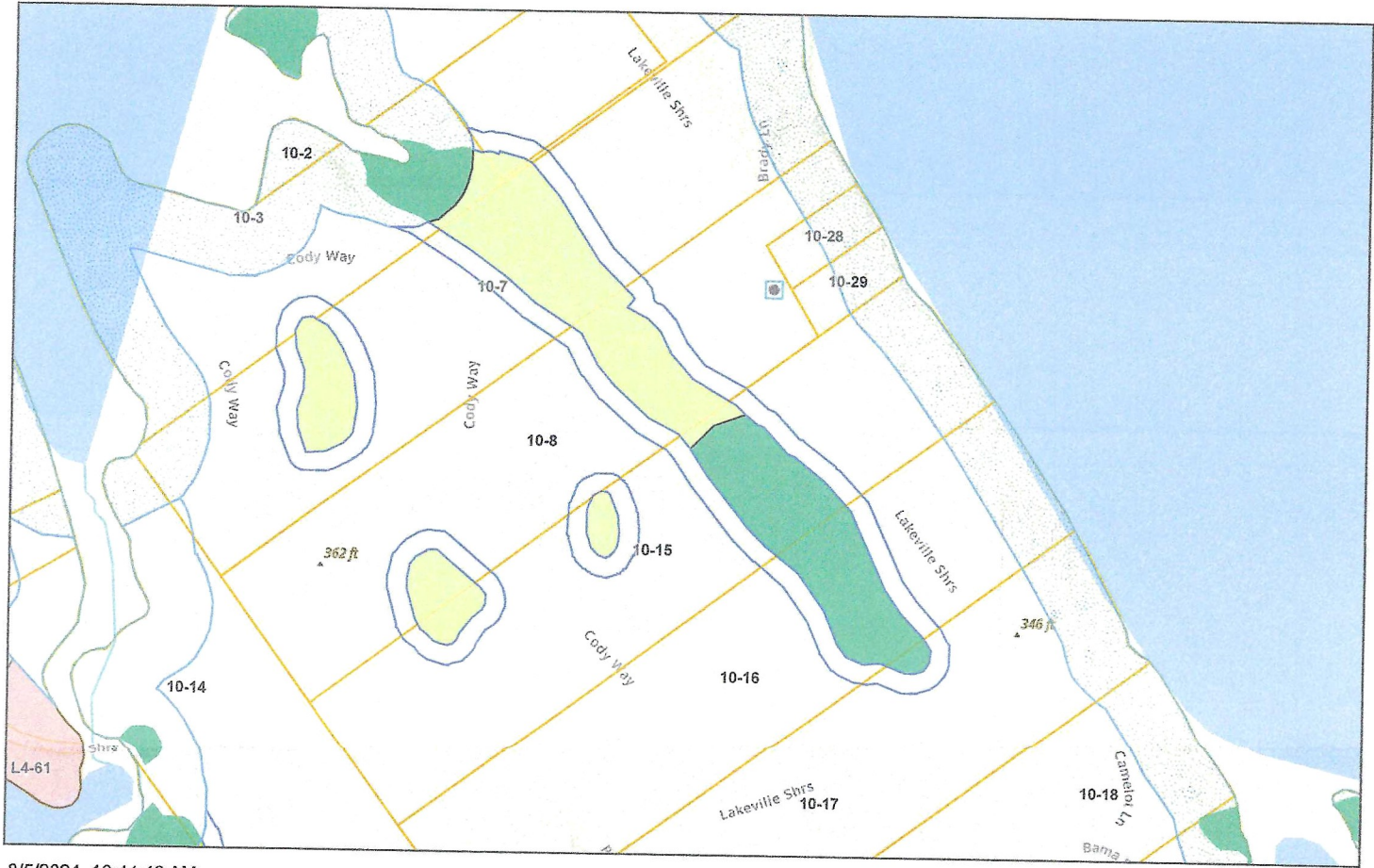

8/5/2024, 10:44:46 AM

Towns

LUPC Zones Layer

D-RS: Residential Development

M-GN: General Management

P-GP: Great Pond Protection

P-SL2: Shoreland - 75' Protection

P-WL1: Wetlands of Special Significance Protection

P-WL2: Scrub-shrub Wetlands Protection

P-WL3: Forested Wetlands Protection

Unorganized Territory Parcels

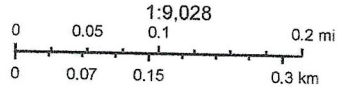

Esri, NASA, NGA, USGS, Esri Community Maps Contributors, Province of New Brunswick, © OpenStreetMap, Microsoft, Esri Canada, Esri, TomTom,

Maine Land Use Planning Commission
2018